

		Conditions	
cell type:		NiMH	
cell size:		C	
nominal voltage:	1.2	V	
max. charge voltage:	1.5	V	at standard charge (0.1C / 20 °C)
capacity			
nominal:	4500	mAh	discharge at 0.2C
minimum:	4000	mAh	discharge at 0.2C
	3600	mAh	discharge at 1C
			1.0V end discharge voltage
			ta: 20 °C
max. continuous discharge current:	4000	mA	ta: 0...45 °C
charge			
standard charge:	450	mA	16hrs
quick charge:	1150	mA	4hrs
fast charge:	2000	mA	2.2hrs
recommended charge termination control parameters:	0...5	mV	- delta V
	0.8...1	°C	temperature rise per minute
	45...50	°C	TCO (temperature cut off)
trickle charge current:	40...200	mA	(recommended)
continuous overcharge: (less than 1 year)	≤ 400	mA	no conspicuous deformation no leakage
internal resistance: (impedance)	≤ 20	mΩ	at 1KHz battery fully charged
life expectancy:	≥ 500	cycles	acc. IEC standard
self discharge			
charge retention: (at ≤ 20 °C ambient)	≥ 85	%	after 6 months storage
	≥ 80	%	after 12 months storage
initial capacity:	≥ 3000	mAh	within 30 days after delivery discharge at 0.2C
ambient temperature range:	0...45	°C	standard charge
	10...40	°C	fast charge
	- 20...65	°C	discharge (≤1.0C)
	0...45	°C	discharge (>1.0C)
	- 20...50	°C	storage (≤3months)
	- 20...40	°C	storage (≤6months)
	- 20...30	°C	storage (≤24months)

QCT1: 20/3800/25
QCT2: 30/3600/30

mechanical specifications		cell dimensions (incl. label)	
diameter d1:		25.8	- 1.0 mm
diameter d2:	max.	7.5	mm
height h1:		50.0	- 2.0 mm
height h2:	min.	1.5	mm
weight:		78	± 4 g
blister card dimensions:		123	x 86 mm
blister card weight (incl. batteries):		161	g

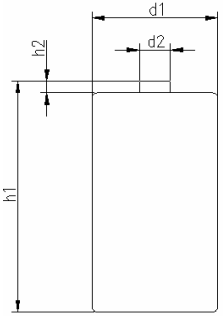

Diagrams

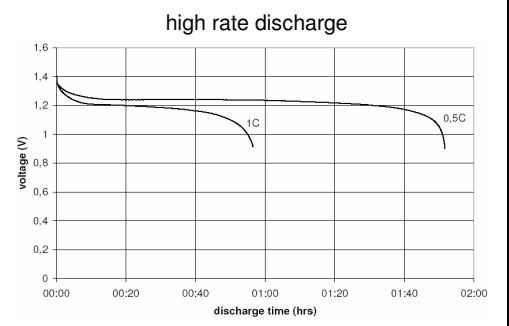
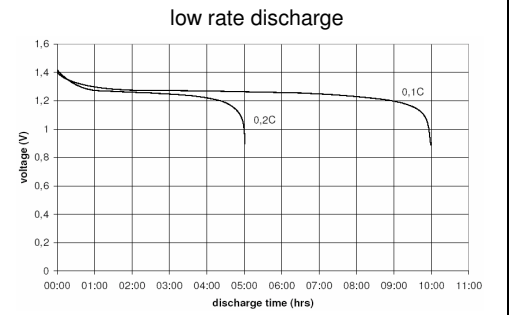
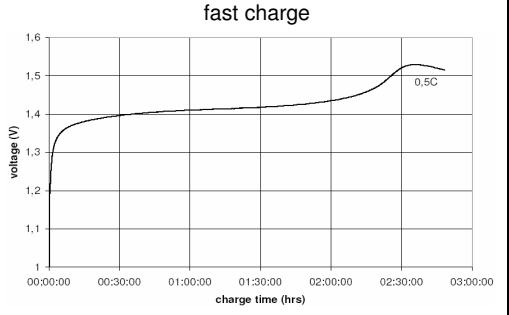
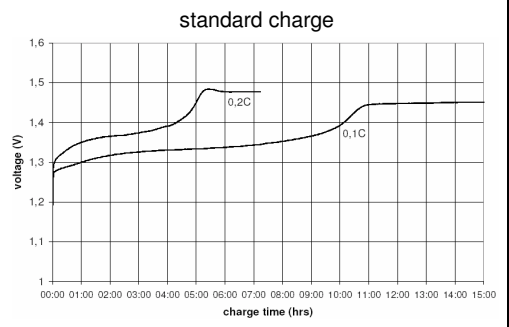

ANSMANN Specifications for model:	C - 4500mAh low self discharge 2pcs blister package
data sheet no. / part no.	5035352
version no.	0
author / date	Gramlich / 19.10.2009

Manufacturer reserves the right to alter or amend the design, model and specification without prior notice