



System:

Zinc/Silver Oxide  
High Drain Type



Scale 2 : 1

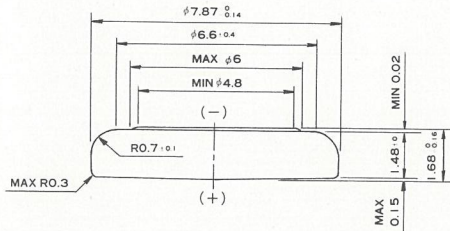

Nominal Voltage: 1.55V

Average Service Capacity: 18mAh  
(Rated capacity at 47,000Ω load  
cut-off voltage 1.2V at 20°C)

Average Weight: 0.3g

Average Volume: 0.06cm<sup>3</sup>

Storage loss at 20°C(68°F): Less than 7% in 1 year

Storage loss at 60°C(140°F): Less than 7% in 20 days

Casing Negative: Nickel Clad

Positive: Nickel Plated Steel

(Unit:mm)

### Discharge Curve

Load: 47,000 Ω

### ● Service Life(at 20°C)

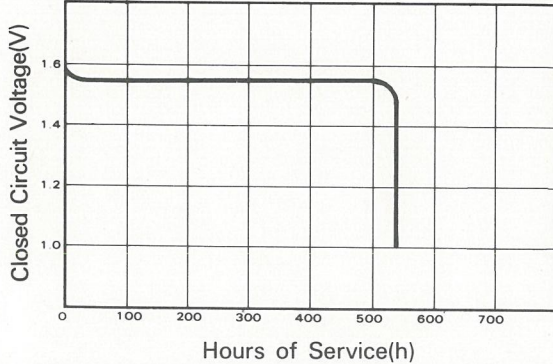

Schedule	Starting Drains (μA)	Load (Ω)	Service Life*
24h/day	33	47,000	542 hours
24h/day	8.7	180,000	2,075 hours
24h/day	2.3	680,000	11 months

\*Cut-off voltage 1.2V

### Closed Circuit Voltage

(at 20°C)

### ● Closed Circuit Voltage

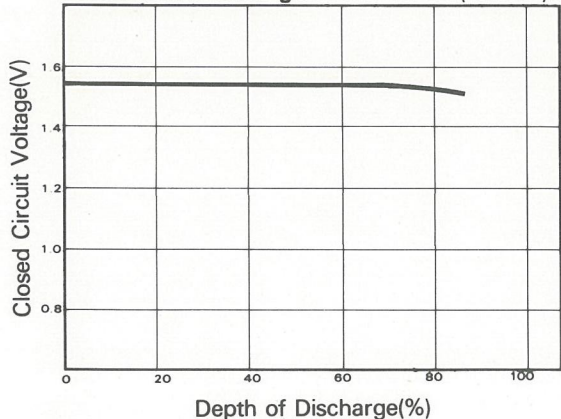

Load	Depth of Discharge	Temperature	
		-10°C	20°C
2,000Ω after 5 seconds	0%	1.40V	1.55V
	40%	1.40V	1.55V
	80%	1.38V	1.54V